

NOTE: OPEN PDF IN ADOBE ACROBAT OR ADOBE READER, SELECT THE LAYERS TAB, THEN TURN ON/OFF DESIRED OPTIONS.

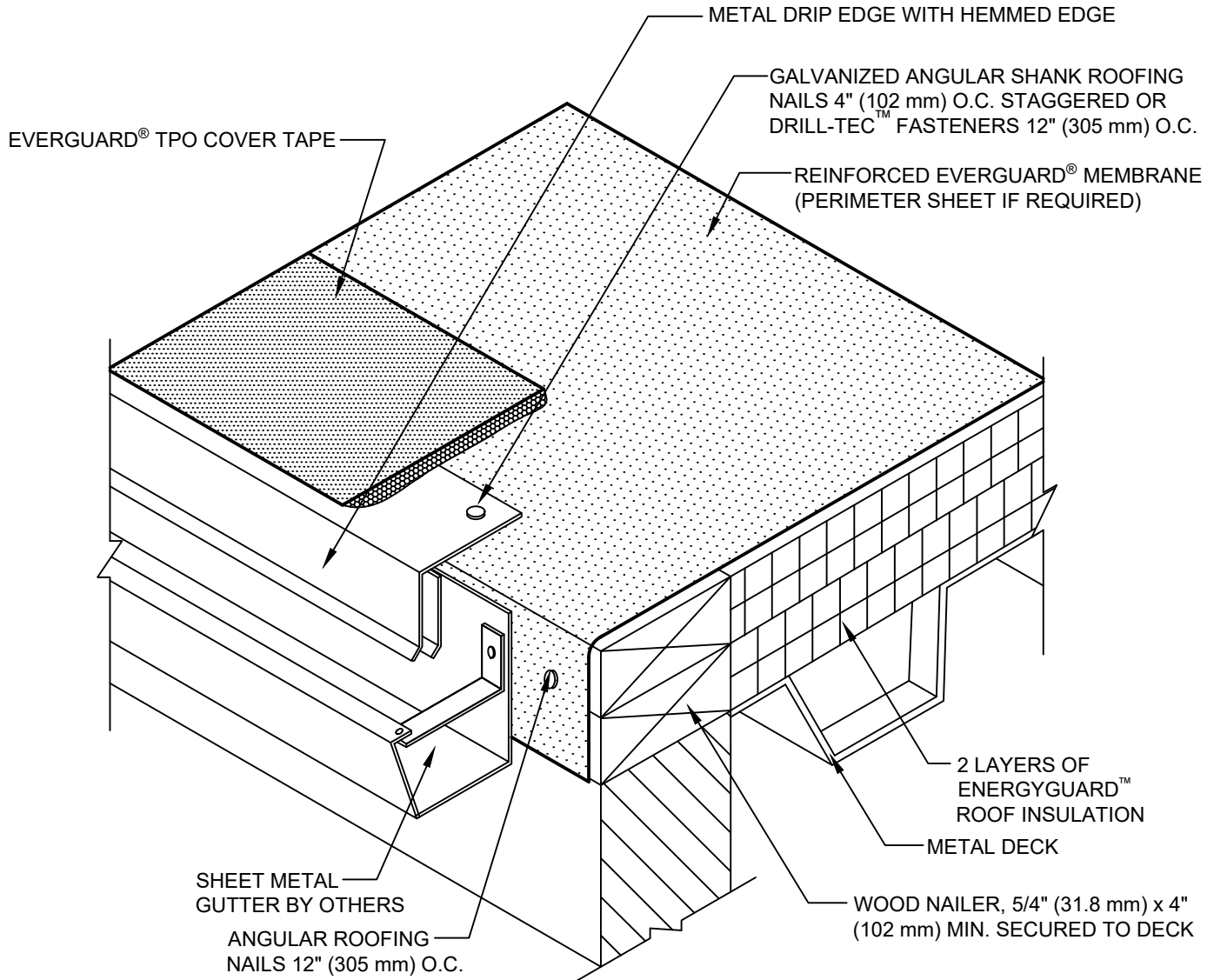

NOTE:

1. THIS DETAIL DRAWINGS IS PROVIDED BY GAF FOR THE SOLE PURPOSE OF OBTAINING A GAF SYSTEM WARRANTY OR GUARANTEE AND IS NOT A SUBSTITUTE FOR PROFESSIONAL DESIGN SERVICES. GAF MAKES NO REPRESENTATION OR WARRANTY WITH RESPECT TO CODE COMPLIANCE OR SUITABILITY OR THIS DETAIL FOR ANY PARTICULAR PROJECT.
2. REFER TO THE APPROPRIATE ATTACHMENT TABLES FOR DETAILED INSTALLATION REQUIREMENTS REGARDING DECK TYPE, PLATE & FASTENER TYPE, AND MIN. EMBEDMENT.
3. CLEAN METAL AND MEMBRANE WITH EVERGUARD® TPO SEAM CLEANER AND ALLOW TO DRY. ONCE DRY, PRIME METAL AND MEMBRANE WITH EVERGUARD® TPO PRIMER BEFORE INSTALLING EVERGUARD® TPO COVER TAPE.
4. THIS DETAIL IS **NOT** TO BE USED ON SLOPES GREATER THAN 1:12. FOR SLOPES GREATER THAN 1:12, REFER TO EVERGUARD® DETAIL 218 OR 219.
5. DO NOT OVERLAP ENDS OF FLASHING STRIP/COVER TAPE.

LEGEND		GUTTER EDGE DETAIL					DETAIL
		PROJECT:					214
NO.	REVISION	DATE	ISSUE DATE	SCALE			
			6/30/22	N.T.S.			