

REAR VIEW OF SCUPPER

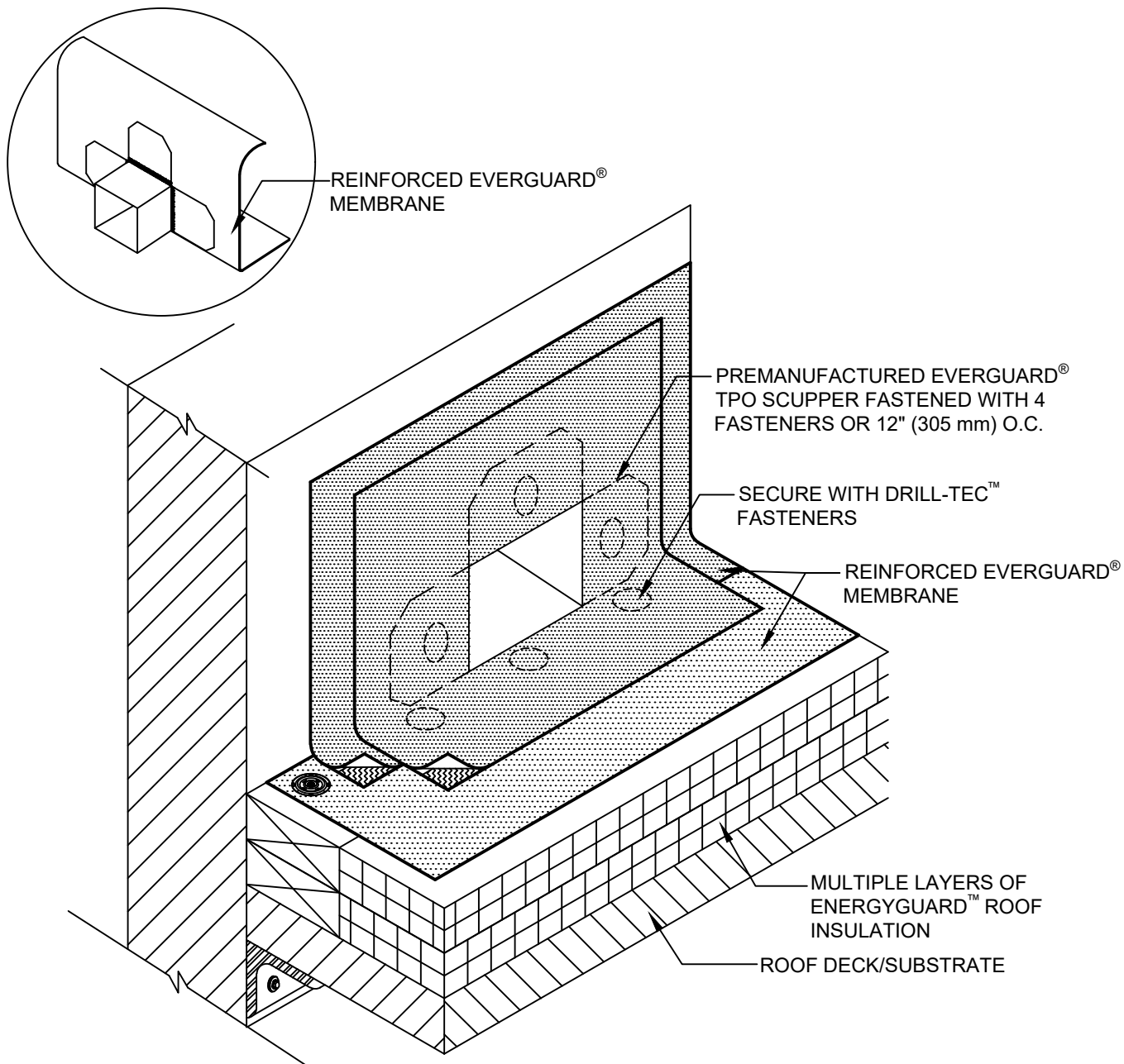

NOTE:

1. DETAIL TO BE USED IN CONJUNCTION WITH STANDARD GUIDE SPECIFICATION CONTAINING REQUIREMENTS FOR NAILERS, INSULATION ETC.
2. FOR INSULATION THICKNESS GREATER THAN 8" (203 mm), A COVER BOARD IS REQUIRED ON MECHANICALLY ATTACHED SYSTEMS ONLY.
3. 25 YEAR GUARANTEES AND ABOVE MUST USE EXTREME ACCESSORIES.
4. SCUPPER MUST ALSO BE SEALED ON OUTSIDE WALL.
5. FOR ALTERNATE BASE ATTACHMENT, REFER TO EVERGUARD® DETAIL 307A.



SCUPPER - PREMANUFACTURED

DRAWING #
324A

THIS DETAIL APPLIES TO:
ALL SYSTEMS

ISSUE / REVISION DATE
8/24/20

SCALE
N.T.S.

LEGEND

 HEAT-WELDED