

**NOTE: OPEN PDF IN ADOBE ACROBAT OR ADOBE READER, SELECT THE LAYERS TAB, THEN TURN ON/OFF DESIRED OPTIONS.**

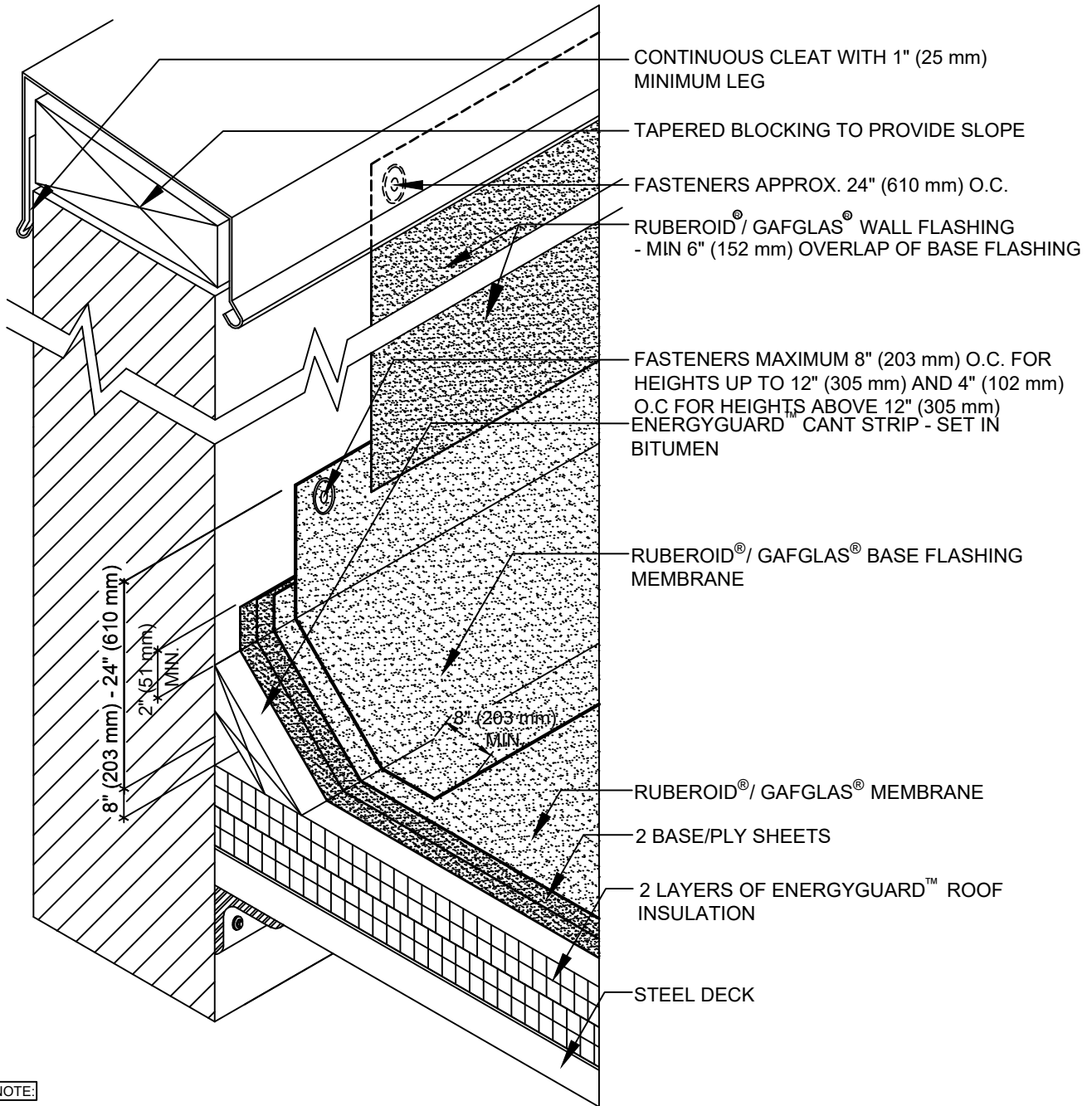

**NOTE:**

1. THIS DETAIL DRAWINGS IS PROVIDED BY GAF FOR THE SOLE PURPOSE OF OBTAINING A GAF SYSTEM WARRANTY OR GUARANTEE AND IS NOT A SUBSTITUTE FOR PROFESSIONAL DESIGN SERVICES. GAF MAKES NO REPRESENTATION OR WARRANTY WITH RESPECT TO CODE COMPLIANCE OR SUITABILITY OR THIS DETAIL FOR ANY PARTICULAR PROJECT.
2. MASONRY WALLS TO BE PRIMED PRIOR TO FLASHING. WOOD WALLS REQUIRE BASE SHEET NAILED TO WALL 8" (203 mm) O.C. ALONG TOP AND LAPS AND 8" (203 mm) O.C. THROUGHOUT THE FIELD OF THE BASE SHEET ON THE WALL.
3. WALL COVERINGS TURNED OVER EDGE A MINIMUM OF 1 1/2" (38mm) OR THICKNESS OF NAILER WHICHEVER IS GREATER.
4. FASTEN BASE FLASHING APPROXIMATELY 8" (203 mm) O.C. FOR HEIGHTS UP TO 12" (305 mm) AND 4" (102 mm) O.C. FOR HEIGHTS UP TO 24" (610 mm).
5. FOR WALL FLASHINGS IN EXCESS OF 4' (1.22 m) CONTACT GAF TECHNICAL SERVICES AT 1-800-ROOF-411.
6. SEALANT AT TOP OF SURFACE-MOUNTED COUNTERFLASHING IS A MAINTENANCE ITEM AND MUST BE MAINTAINED THROUGHOUT THE LIFE OF THE ROOF TO ENSURE A WATERTIGHT SEAL.

LEGEND		WALL FLASHING DETAIL					DETAIL
		PROJECT:					310
	NO.	REVISION	DATE	ISSUE DATE	SCALE		
				6/30/22	N.T.S.		