

Perimeter Edge Metal

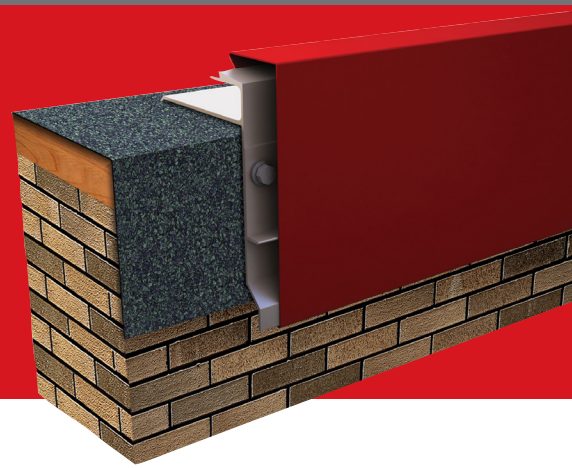

Description:

M-Weld™ Pro HG Fascia is a snap-on system that protects against tough weather conditions. It is tested to provide superior protection from wind pressure versus field-fabricated gravel stops. The unique design of the extruded aluminum bar with pre-punched holes securely terminates asphaltic membranes. It can also help increase contractor productivity with its ease of installation.

Features and Benefits:

- Fast and easy installation, eliminating the need for "stripping in" that is typical of other roof edge designs.
- Sizes range from 5½" – 7" (140 mm – 178 mm) face heights to accommodate multiple nailers and wall requirements.
- M-Weld™ Pro HG Standard Fascia can be manufactured in 22 ga. and 24 ga. galvanized steel or .040", .050", and .063" aluminum.

- Factory-fabricated miters, scuppers, and drainage accessories provide a clean, aesthetically pleasing appearance, and can help save time by eliminating the need for field fabrication.
- Express, standard, and premium colors and finishes are available to meet your job requirements and include a 30-year limited Kynar 500® finish warranty on coil-coated standard colors. For warranty details, please visit gaf.com.
- Custom colors are also available. A 10-year limited warranty is included for post-painted Kynar®-coated aluminum applications unless otherwise stated. A 20-year limited warranty may be available upon request for certain colors.*

*Restrictions apply; consult your GAF Territory Manager for more information.

Codes/Testing Compliance:

- Evaluated in accordance with ANSI/SPRI ES-1, which is a requirement of IBC Section 1504.5 for roof system metal edge securement.
- FM Approved per Approval Standard 4435. Refer to RoofNav.com product detail report for approved uses, requirements, and ratings.
- Miami-Dade County Product Control Approved



10 Express Colors¹

Express Colors are available for quick shipping to meet your job requirements.²



For standard and premium colors, please refer to the GAF color chart, available at gaf.com/perimeteredgemetal. Custom colors are also available.

¹ Express Colors available in shorter lead times for 24 ga., .040", and .050" only. Standard lead times, which may be longer, apply for 22 ga. and .063".

² It is difficult to reproduce the color clarity of these products. Before selecting your color, please contact your local GAF territory manager to request a paint chip for accurate color representation.

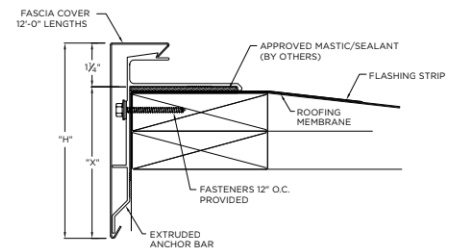

Product Specifications

	M-Weld™ Pro HG Fascia
STANDARD SIZES	5.5 in. (127 mm) 7 in. (178 mm)
LENGTH	12 ft. (6.10 m)
MATERIALS	22 ga. galvanized steel 24 ga. galvanized steel .040 in. / .050 in. / .063 in. aluminum
FINISHES	Mill aluminum Pre-finished Kynar 500® (See standard color chart) Premium pre-finished Kynar 500® (See standard color chart) Post-finished Kynar 500® Pre-finished anodized aluminum — clear, bronze, or black Post-finished anodized aluminum Custom post-coated Kynar 500® finishes are available
PRE-PUNCHED HOLES	12 in. (305 mm) o.c.



Visit gaf.com/PerimeterEdgeMetal

We protect what matters most™

