

Perimeter Edge Metal

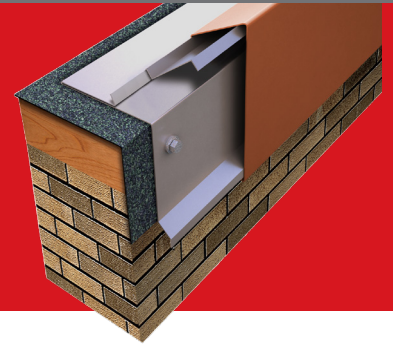

Description:

M-Weld™ One Edge Fascia and M-Weld™ One Edge Extended Fascia are snap-on fascia systems that eliminate crimping, substantially reducing installation time on built-up (BUR) and modified roofing systems. The cleat is formed out of 20 ga. galvanized steel with pre-punched holes to help ensure proper fastening and thermal movement. It can also help increase contractor productivity with its ease of installation.

Features and Benefits:

- Fast and easy installation, eliminating the need for “stripping in” that is typical of other roof edge designs.
- M-Weld™ One Edge Fascia sizes range from 5" (127 mm) – 8" (203 mm) face heights to accommodate multiple nailers and wall requirements.
- M-Weld™ One Edge Extended Fascia sizes range from 9.5" (241 mm) – 12.5" (318 mm) face heights to accommodate multiple nailers and wall requirements.
- M-Weld™ One Edge Fascia is eligible for the Rapid Edge quick ship program.[†]
- Factory-fabricated miters, scuppers, and drainage accessories provide a clean, aesthetically pleasing appearance, and can help save time by eliminating the need for field fabrication.
- Express, standard, and premium colors and finishes are available to meet your job requirements, and include a 30-year limited Kynar 500® finish warranty on coil-coated standard colors. For warranty details, please visit gaf.com.
- Custom colors are also available. A 10-year limited warranty is included for post-painted Kynar®-coated aluminum applications unless otherwise stated. A 20-year limited warranty may be available upon request for certain colors.*

* Restrictions apply; consult your GAF Territory Manager for more information.

[†] Available for M-Weld™ One Edge Fascia in 24 ga. (steel) and 0.040" (alum.) and in Express Colors only. US delivery only. Orders received before 10:00 a.m. Eastern time will be processed within three business days, provided that the information supplied is complete and accurate. Any changes to the original order may delay shipping. Actual shipping time may vary depending upon delivery location. Other restrictions apply.

Product Specifications	M-Weld™ One Edge Fascia	M-Weld™ One Edge Extended Fascia
STANDARD SIZES	5" (127 mm) 6.5" (165 mm) 8" (203 mm)	9.5" (241 mm) 11" (279 mm) 12.5" (318 mm)
LENGTH	12' (3.65 m)	
MATERIALS	<ul style="list-style-type: none"> 22 ga. galvanized steel 24 ga. galvanized steel .040" aluminum 	<ul style="list-style-type: none"> 22 ga. galvanized steel .050" aluminum .063" aluminum
FINISHES	Mill aluminum Pre-finished Kynar 500® (See standard color chart) Premium pre-finished Kynar 500® (See standard color chart) Post-finished Kynar 500® Pre-finished anodized aluminum — clear, bronze, or black Post-finished anodized aluminum Custom post-coated Kynar 500® finishes are available	
PRE-PUNCHED HOLES	12" (305 mm) o.c.	

Codes and Compliance:

- Evaluated in accordance with ANSI/SPRI ES-1, which is a requirement of IBC Section 1504.5 for roof system metal edge securement
- FM Approved per Approval Standard 4435. Refer to RoofNav.com product detail report for approved uses, requirements and ratings.
- Miami-Dade County Product Control Approved



Express Colors¹ available for quick shipping²



For standard and premium colors, please refer to the GAF color chart, available at gaf.com/PerimeterEdgeMetal. Custom colors are also available.

¹ Express Colors available in shorter lead times for 24 ga., .040", and .050" only. Standard lead times, which may be longer, apply for 22 ga. and .063".

² It is difficult to reproduce the color clarity of these products. Before selecting your color, please contact your local GAF territory manager to request a paint chip for accurate color representation.

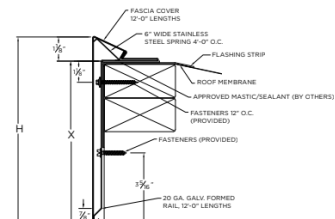
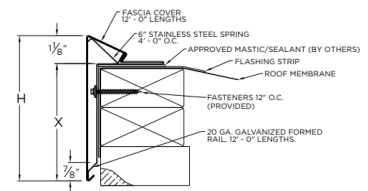

Visit gaf.com/PerimeterEdgeMetal

We protect what matters most™

