

Perimeter Edge Metal

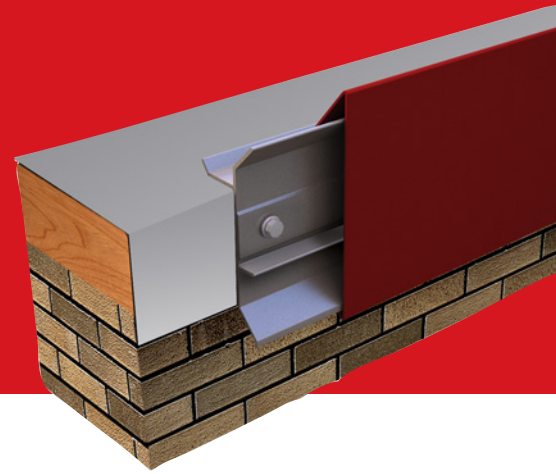
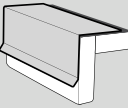

Description:

EverGuard® Pro Fascia and EverGuard® Pro Extended Fascia compose a snap-on system that protects against tough weather conditions. The unique design of the extruded aluminum bar with pre-punched holes securely terminates single-ply membranes and provides superior protection versus formed shop-fabricated bars. It can also increase productivity with its ease of installation.

Features and Benefits:

- EverGuard® Pro Fascia sizes range from 4" – 8 ½" (102 mm – 216 mm) face heights to accommodate multiple nailers and wall requirements.
- EverGuard® Pro Extended Fascia sizes range from 8 ½" – 13" (216 mm - 330 mm) face heights.
- EverGuard® Pro Fascia covers can be manufactured in 22 ga., 24 ga., or .040" aluminum.

- EverGuard® Pro Extended Fascia covers can be manufactured in 22 ga. galvanized steel or .050" and .063" aluminum.
- Factory-fabricated miters, scuppers, and drainage accessories provide a clean aesthetic and can help save time by eliminating the need for field fabrication.
- Express, standard, and premium colors and finishes are available and include a 30-year limited Kynar 500® finish warranty on coil-coated standard colors. For warranty details, please visit gaf.com.
- Custom colors are also available. A 10-year limited warranty is included for post-painted Kynar®-coated aluminum applications unless otherwise stated. A 20-year limited warranty may be available upon request for certain colors.*

* Restrictions apply; consult your GAF Territory Manager for more information.

Codes and Compliance:

- Tested in accordance with ANSI/SPRI/ FM 4435/ES-1 Standard to comply with the International Building Code.
- FM-approved for wind uplift protection. Refer to RoofNav.com for actual assemblies.



10 Express Colors¹

Express Colors are available for quick shipping to meet your job requirements.²



For standard and premium colors, go to the GAF color chart, available at gaf.com/perimeteredgemetal. Custom colors are also available.

¹ Express Colors available in shorter lead times for 24 ga., .040", and .050" only. Standard lead times, which may be longer, apply for 22 ga. and .063".

² It is difficult to reproduce the color clarity of these products. Before selecting your color, please contact your local GAF territory manager to request a paint chip for accurate color representation.

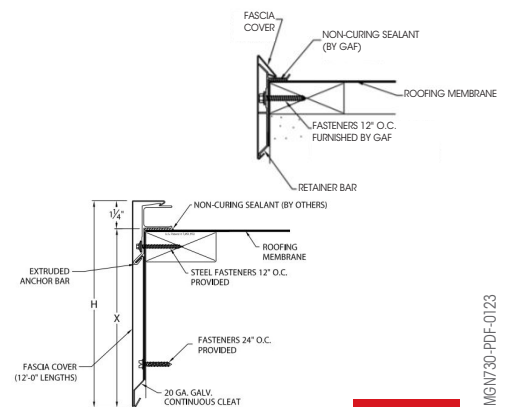

Product Specifications

	EverGuard® Pro Fascia	EverGuard® Pro Extended Fascia
STANDARD SIZES	4 in. (102 mm) 5.5 in. (127 mm) 7 in. (177.8 mm) 8.5 in. (216 mm)	8.5 in. (216 mm) 10 in. (254 mm) 11.5 in. (292 mm) 13 in. (330 mm)
LENGTH	12 ft. (6.10 m)	
MATERIALS	22 ga. galvanized steel 24 ga. galvanized steel (Pro Fascia only) .040" aluminum (Pro Fascia) .050" and .063" aluminum (Pro Extended Fascia)	
FINISHES	Mill aluminum Pre-finished Kynar 500® (See standard color chart) Premium pre-finished Kynar 500® (See standard color chart) Post-finished Kynar 500® Pre-finished anodized aluminum — clear, bronze, or black Post-finished anodized aluminum Custom post-coated Kynar 500® finishes are available	
PRE-PUNCHED HOLES	12 in. (305 mm) o.c.	



Visit gaf.com/PerimeterEdgeMetal

We protect what matters most™

