

# Perimeter Edge Metal

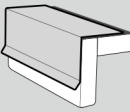

## EverGuard® GAF Fascia



### Description:

EverGuard® Fascia is composed of a snap-on cover that eliminates crimping, substantially reducing installation time on single-ply roofs. Dual attachment points on both the face and roof deck allow for added flexibility when accommodating roof irregularities. With no exposed fasteners and no unsightly cover plates, Everguard® Fascia will complement the building's aesthetics, while also being fast and easy to install.

### Features and Benefits:

- EverGuard® Fascia sizes range from 5 1/4" – 12 3/4" (139.7 mm – 323.85 mm) face heights to accommodate multiple nailers and wall requirements.
- EverGuard® Fascia covers can be manufactured in 22 ga., 24 ga. steel, or .040", .050", and .063" aluminum.

- Factory-fabricated miters, scuppers, and drainage accessories provide a clean aesthetic and can help save time by eliminating the need for field fabrication.
- Express, standard, and premium colors and finishes are available and include a 30-year limited Kynar 500® finish warranty on coil-coated standard colors. For warranty details, please visit gaf.com.
- Custom colors are also available. A 10-year limited warranty is included for post-painted Kynar®-coated aluminum applications unless otherwise stated. A 20-year limited warranty may be available upon request for certain colors.\*

\* Restrictions apply; consult your GAF Territory Manager for more information.

### Codes and Compliance:

- Tested in accordance with ANSI/SPRI/FM 4435/ES-1 Standard to comply with the International Building Code.
- FM-approved for wind uplift protection. Refer to RoofNav.com for actual assemblies.



### 10 Express Colors<sup>1</sup>

Express Colors are available for quick shipping to meet your job requirements.<sup>2</sup>



For standard and premium colors, go to the GAF color chart, available at [gaf.com/perimeteredgemetal](http://gaf.com/perimeteredgemetal). Custom colors are also available.

<sup>1</sup> Express Colors available in shorter lead times for 24 ga., .040", and .050" only. Standard lead times, which may be longer, apply for 22 ga. and .063".

<sup>2</sup> It is difficult to reproduce the color clarity of these products. Before selecting your color, please contact your local GAF territory manager to request a paint chip for accurate color representation.

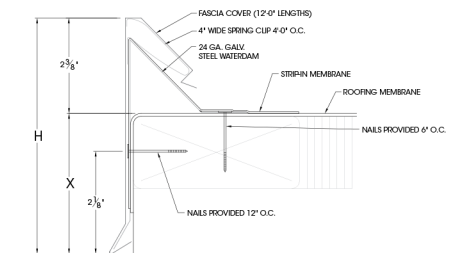

### Product Specifications

<b>STANDARD SIZES</b>	5.25" (139.7 mm) 6.75" (171.45 mm) 8.25" (209.55 mm) 9.75" (247.65 mm) 11.25" (285.75 mm) 12.75" (323.85 mm)
<b>LENGTH</b>	12 ft. (6.10 m)
<b>MATERIALS</b>	22 ga. galvanized steel 24 ga. galvanized steel .040" aluminum .050" and .063" aluminum
<b>FINISHES</b>	Mill aluminum Pre-finished Kynar 500® (See standard color chart) Premium pre-finished Kynar 500® (See standard color chart) Post-finished Kynar 500® Pre-finished anodized aluminum — clear, bronze, or black Post-finished anodized aluminum Custom post-coated Kynar 500® finishes are available
<b>PRE-PUNCHED HOLES</b>	12 in. (305 mm) o.c. on the face/6" o.c. (152 mm) on the flange



Visit [gaf.com/PerimeterEdgeMetal](http://gaf.com/PerimeterEdgeMetal)

We protect what matters most™

**GAF**